



Truscott Avenue, Swindon, SN25 2PQ

01793 840 222 | alanhawkins.co.uk

alan
hawkins
alan
hawkins
PROPERTY SALES & LETTINGS



- Top Floor Apartment
- Occupying Its Own Floor
- En-Suite Shower Room
- Welcoming Entrance Hallway
- Allocated Parking To The Rear

- Beautifully Presented Throughout
- Two Double Bedrooms
- Open Plan Kitchen/Diner/Living Room
- Secure Communal Front Entrance To Building
- No Onward Chain

62 Truscott Avenue Swindon, SN25 2PQ

£160,000

A beautifully presented two bedroom top floor apartment, ideally situated close to a wide range of local amenities and excellent transport links whilst also offering easy access to the A419 and other major routes. Forming part of an exclusive block of just three apartments, with the property occupying the entire top floor, this stylish home would make an ideal first time purchase, investment opportunity or downsize alike. Furthermore, the property is currently tenanted, making it an attractive ready-made investment opportunity for any prospective landlord.

The accommodation briefly comprises a welcoming entrance hallway with useful storage, two generous double bedrooms with the principal bedroom benefiting from an en-suite shower room whilst bedroom two also enjoys a built-in storage cupboard. In addition, there is a modern family

bathroom fitted with an additional shower.

A particular feature of the property is the impressive open plan lounge/diner and kitchen creating a bright and sociable living space. The contemporary kitchen is finished in a modern grey colour scheme and comes equipped with an integrated cooker along with a fridge freezer and washing machine. French doors from the lounge open onto a Juliet style balcony allowing plenty of natural light to flood the room.

Further benefits include a secure communal entrance, private allocated parking to the rear, gas central heating and double glazing throughout. Overall, this is a superb opportunity to acquire a well maintained and spacious apartment suited equally to owner occupiers and investors alike.



Viewings

By appointment through Alan Hawkins Property Sales. Tel: 01793 840 222

Council Tax: Swindon Borough Council

Tax Band C For year 2026/27 = £2105.75
For information on tax banding and rates, please call Swindon Borough Council

Tenure

Leasehold

Management Fee

Leasehold. c89 Years remaining (as of 2026)
Ground Rent & Service Charge Combined. - TBC
Gas - Mains
Electric - Mains
Water - Mains
Drainage - Mains
Internet - Up to 76* Mbps available download speed







Energy Efficiency Rating

	Current	Potential
Very energy efficient - lower running costs		
(92 plus) A		
(81-91) B	81	81
(69-80) C		
(55-68) D		
(39-54) E		
(21-38) F		
(1-20) G		
Not energy efficient - higher running costs		

England & Wales EU Directive 2002/91/EC 

SECOND FLOOR
629 sq.ft. (58.4 sq.m.) approx.

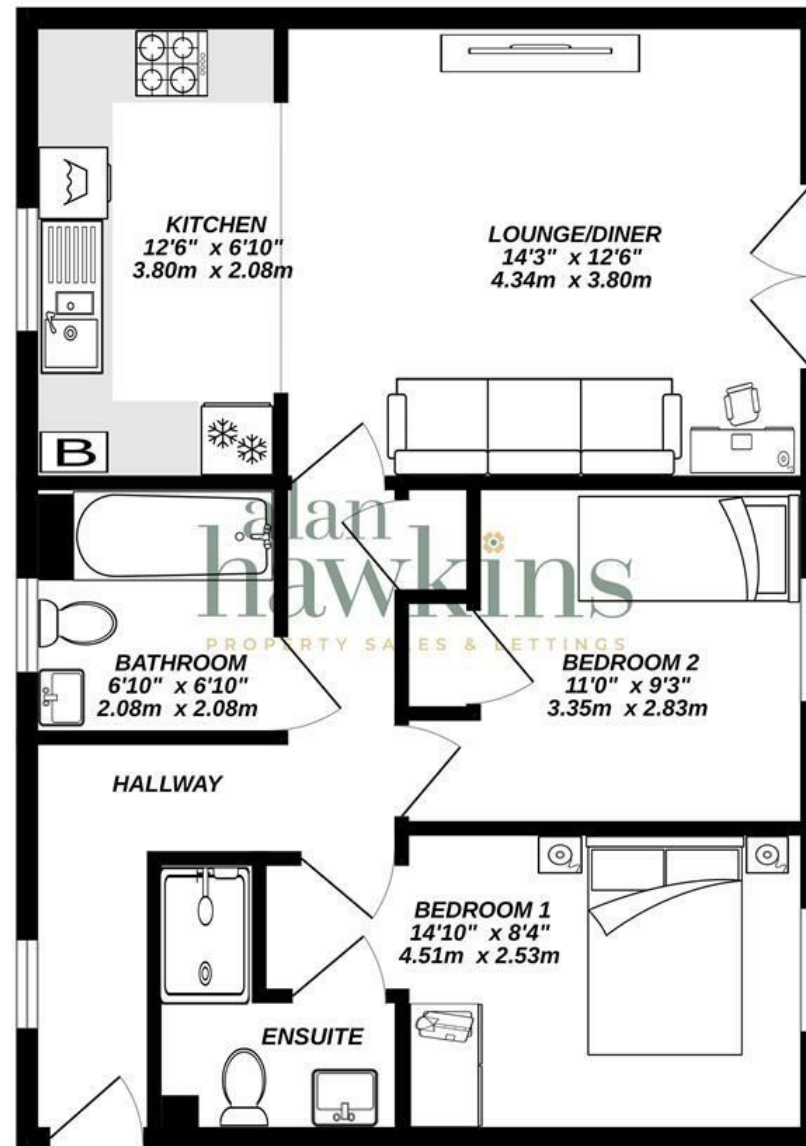

TOTAL FLOOR AREA : 629 sq.ft. (58.4 sq.m.) approx.

Whilst every attempt has been made to ensure the accuracy of the floorplan contained here, measurements of doors, windows, rooms and any other items are approximate and no responsibility is taken for any error, omission or mis-statement. This plan is for illustrative purposes only and should be used as such by any prospective purchaser. The services, systems and appliances shown have not been tested and no guarantee as to their operability or efficiency can be given.
Made with Metropix ©2026



alan hawkins

PROPERTY SALES & LETTINGS

01793 840 222 | alanhawkins.co.uk

Alan Hawkins

26/26a High Street,
Royal Wootton Bassett
Wiltshire, SN4 7AA

Disclaimer: These particulars are believed to be correct but their accuracy cannot be guaranteed. They do not form part of the contract and Alan Hawkins Estate Agents are not to be held liable in any way for any mistakes or inaccuracies in these particulars. The agents have not tested any apparatus,

equipment, fixtures or services and so cannot verify they are in working order, or fit for their purposes, neither have the agents checked the legal documents to verify the freehold/leasehold status of the property. The buyer is advised to obtain verification from their solicitor/surveyor.

